

Adapting PD Catheter Connections to Alternate PD Delivery Systems

▼

This brochure outlines procedures to safely and securely adapt a peritoneal dialysis (PD) patient's catheter extension set to an alternate PD delivery system in a clinical setting.

This includes:

- Connecting a Fresenius Renal Technologies PD system to an alternate PD system
- Connecting an alternate PD system to a Fresenius Renal Technologies Group PD system

Connecting a stay-safe Patient to an Alternate PD System

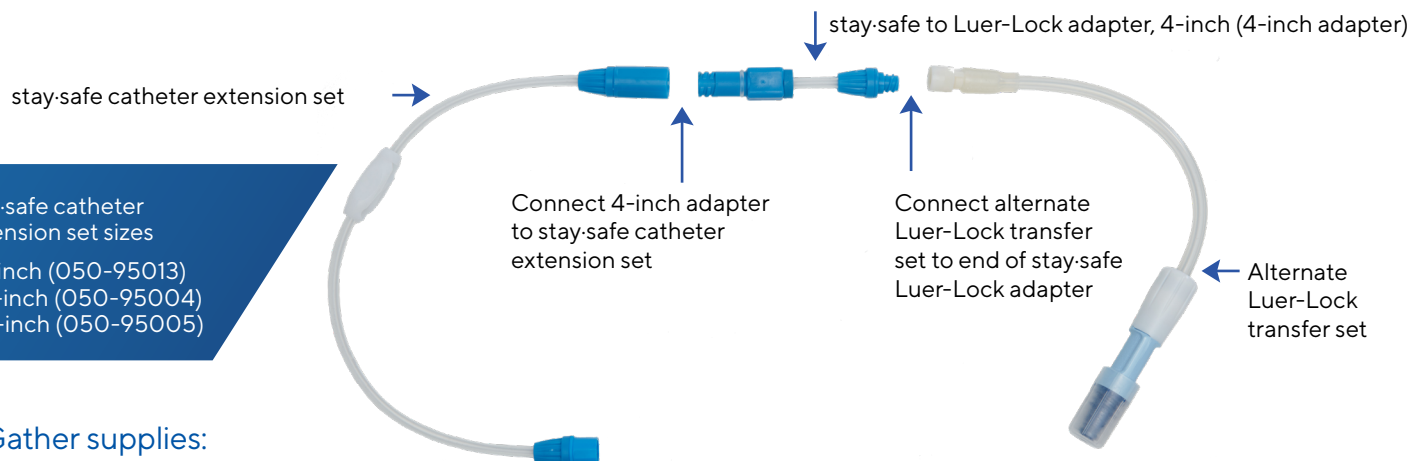

stay-safe catheter extension set sizes

- 6-inch (050-95013)
- 12-inch (050-95004)
- 18-inch (050-95005)

1. Gather supplies:



- stay-safe Luer-Lock adapter, 4-inch (050-95003). Check the expiration date.
- Alternate Luer-Lock transfer set.
- Alternate PD system (CAPD or APD delivery system).
- Face masks and gloves as required by the center's policy.

Use aseptic technique throughout the procedure

2. Prepare work area per center procedure. Mask self, patient, and anyone who must remain in the room.
3. Wash hands. Put on gloves, as required by your center's policy.
4. Make sure clamp on stay-safe catheter extension set is closed.

5. Remove white cap from squared end of 4-inch adapter.



6. Remove stay-safe cap from stay-safe catheter extension set.



7. Immediately connect 4-inch adapter to stay-safe catheter extension set.



8. Pull ring off the end of the alternate Luer-Lock transfer set.



Connecting a stay-safe Patient to an Alternate PD System (continued)

9. Remove white cap from 4-inch adapter (already connected to stay-safe catheter extension set).

10. Immediately connect alternate Luer-Lock transfer set to end of 4-inch adapter.

11. Connect alternate PD system per manufacturer's instructions.

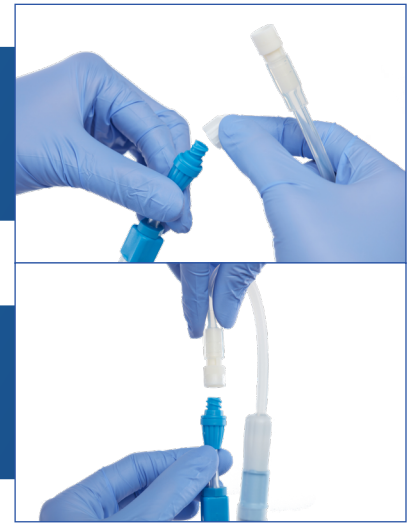

Leave the 4-inch adapter and alternate Luer-Lock transfer set in place for the duration of the patient's hospital stay, unless hospitalization exceeds six months.

Important hospital discharge instruction for the patient:

- When making the initial PD connection at home, always use aseptic technique when removing and discarding the 4-inch adapter and the alternate Luer-Lock transfer set.
- Then connect the Fresenius PD system directly to the stay-safe catheter extension set.

Connecting an Alternate PD System Patient to a stay-safe PD System

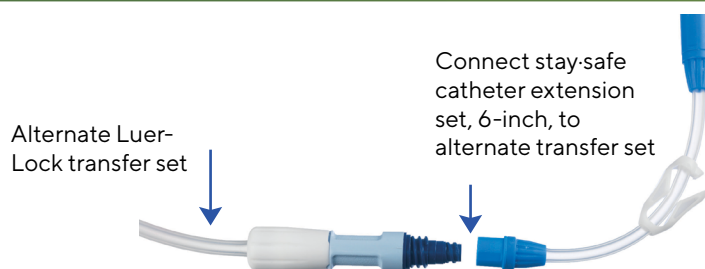

1. Gather supplies:



- stay-safe catheter extension set with Luer-Lock, 6-inch (050-95013). Check expiration date.
- stay-safe PD system (CAPD or APD delivery system).
- Face masks and gloves, as required by your center's policy.

Use aseptic technique throughout the procedure

2. Prepare work area per center procedure. Mask self, patient, and anyone who must remain in the room.
3. Wash hands. Put on gloves, as required by your center's policy.
4. Make sure the twist clamp on the alternate Luer-Lock transfer set is closed. Refer to that manufacturer's instructions.

Connecting an Alternate PD System Patient to a stay-safe PD System

(continued)

5. Remove blue sterility cap from stay-safe catheter extension set.



6. Twist protective cap off of alternate Luer-Lock transfer set.



7. Immediately connect stay-safe catheter extension set to alternate Luer-Lock transfer set.

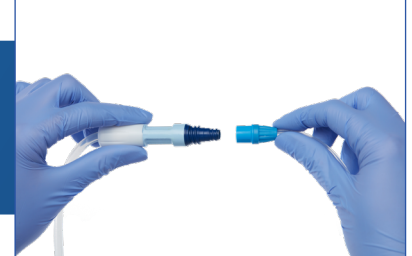

8. Connect Fresenius PD system per manufacturer's instructions.

9. Open clamp on alternate Luer-Lock transfer set.

Leave the stay-safe catheter extension set in place for the duration of the patient's hospital stay, unless hospitalization exceeds six months.

Important hospital discharge instruction for the patient: When making the initial PD connection at home, always use aseptic technique when removing and discarding the stay-safe catheter extension set.

Read the Instructions for Use for safe and proper use of these devices. For a complete description of hazards, contraindications, side effects, and precautions, see full package labeling at fmcna.com.

Indications for Use: The stay-safe catheter extension set with Luer-Lock is indicated for use in patients with acute and chronic end-stage renal disease undergoing peritoneal dialysis (PD) in a healthcare facility or at home. The stay-safe catheter extension set with Luer-Lock is used to connect a PD catheter with a Luer-Lock catheter adapter to PD systems that use stay-safe PIN technology.

The stay-safe to Luer-Lock adapter is indicated for use in patients with acute and chronic end-stage renal disease undergoing peritoneal dialysis (PD) in a healthcare facility or at home. The stay-safe to Luer-Lock adapter is used to connect a stay-safe catheter extension set to medical devices with a Luer-Lock connection.

The stay-safe patient connectors are intended for use with a peritoneal dialysis (PD)ycler for drainage and infusion of PD solution during PD exchanges. The stay-safe patient connectors are indicated for use in acute and chronic peritoneal dialysis.

Caution: Federal (U.S.) law restricts this device to sale by or on the order of a physician.

stay-safe is manufactured by Fresenius Medical Care.

© 2011–2021 Fresenius Medical Care. All Rights Reserved. Fresenius Medical Care, the triangle logo, Fresenius Renal Technologies, stay-safe, and Safe-Lock are trademarks of Fresenius Medical Care Holdings, Inc., or its affiliated companies. All other trademarks are the property of their respective owners. P/N 101419-01 Rev B 10/2021